



**WHAT'S IN THE BOXES**

Frame Box: (1) Eclipse™ Frame, Allen Wrench and 7/16 Wrench  
 Top Box: (1) Fabric Top and (1) Cover Bag

**ONE-TIME TOP INSTALLATION**

**REFER TO BOTTOM OF PAGE FOR 10' x 20' MODEL INSTRUCTIONS**

**Unpack and Open**

1. Place your E-Z UP® **Frame** in the center of the area to be sheltered.
2. With a partner on the opposite side of the **Frame**, grasp two outer legs, lift the **Frame** slightly off the ground, and step backward while pulling the **Frame** to open.
3. Stop when the **Frame** is approximately ¾ of its fully-opened size. (Fig. A)
4. Set the **Frame** back on the ground.

**Attach Fabric Top**

5. Gently unfold the **Fabric Top**, and place it over the semi-opened **Frame**.
6. Attach the **Fabric Top** to the E-Z UP® **Frame** by matching the **Hook and Loop Strips** on the inside of the **Fabric Top** corners with the **Hook and Loop Strips** on each **Frame** corner. (Fig. B)
7. Pull the **Fabric Top** down over the **Frame** corners—pushing the **Hook and Loop Strips** firmly together.

**Secure Top to Frame**

8. Line up the grommet holes on the sides of the **Fabric Top** to the frame **Top Attachment Points**. The **Top Attachment Points** on the **Frame** are denoted by the RED tags. (Fig. C)
9. Using a coin, unscrew the **Top Attachment Nut** from the frame bolt. (Fig. D)
10. Place **Fabric Top** grommet on the Frame bolt.
11. Screw on **Top Attachment Nut** and tighten until snug. **Fabric Top** should rotate easily. **Do not** over-tighten.
12. Repeat this procedure at each of the **Top Attachment Points**.

Note: Hold the bolt assembly with one hand while tightening the top attachment nut with your other hand.

**SET UP**

**OPEN E-Z UP® Shelter**

1. With a partner on the opposite side, grasp the bottom of the diamond-shaped area of **Outer Trusses** near the "OPEN HERE" sticker. (Fig. A)
  2. Lift the **Frame** up slightly and step backward until the shelter is almost fully opened. Gently shake the shelter while opening. *Be careful not to pinch fingers!*
- For 10' x 15' (3.0m x 4.5m) MODEL ONLY:  
 Complete the above instructions on the 10' (3.0m) side of the shelter.

**Secure Auto-Slider® Pull Pin**

3. Fold up the **Fabric Top** corner to expose the **Auto-Slider® Pull Pin**. (Fig B)
4. Lift shelter corner slightly off the ground and engage the **Auto-Slider® Pull Pin** by pushing up on the **Frame** side trusses with one hand while holding down the top of the **Frame Leg** with the other hand. The pins will auto-engage when aligned with the holes on the **Frame Legs**.
5. After the **Auto-Slider® Pull Pin** has locked into place, pull the **Fabric Top** down over the **Frame Leg**, making sure to align and secure the hook and loop strips on the **Fabric Top** to the **Frame**.
6. Repeat on all remaining corners.

**Extend Frame Legs**

7. With a partner, lift the two adjacent outer legs up off the ground simultaneously to about waist height.
  8. Slide the lower/inner legs out until the **Leg Adjustment Toggle** buttons lock at selected height on each leg. (Fig. C)
- Note: There are 5 adjustment settings on each leg.
9. Lower middle leg until the toggle button locks.
  10. Repeat on the remaining legs.
- Note: It is recommended that you use genuine E-Z UP® Deluxe Weight Bags and/or Heavy-Duty Stake Kits to secure your shelter.

**Your E-Z UP® shelter setup is now complete!**

**FOR 10' X 20' MODELS (3.0M X 6.0M)**

**Unpack and Open**

1. Place your E-Z UP® **Frames** in the center of the area to be sheltered.
2. With a partner on the opposite side of the **Frame**, gently expand both the **Main Frame (A)** and **Sub-Frame (B)** to approximately half of their fully-opened size. (Fig. A)
3. Face open ends of the trusses to align the bracket attachment points on each frame.

**Connect Frames**

4. Remove bolt assembly (nut and bolt) from each bracket on **Main Frame (A)**.
  5. Insert truss end from **Sub-Frame (B)** (labeled "A" for top and "B" for bottom) into the corresponding attachment point on the **Main Frame (A)** and align holes.
  6. Use the nut and bolt that was previously removed to secure the truss. Tighten the nut and bolt securely using the enclosed **Allen Wrench** and **7/16 wrench**. (Fig. B)
- Note: Hold the bolt assembly with one hand while tightening the Top Attachment Nut with your other hand. Do not over-tighten bolts—they should rotate easily. Connection points must rotate in order for shelter to open properly. Over-tightening will result in broken trusses.
7. Repeat these steps for all six connection points (3 top points labeled "A" and 3 bottom points labeled "B").

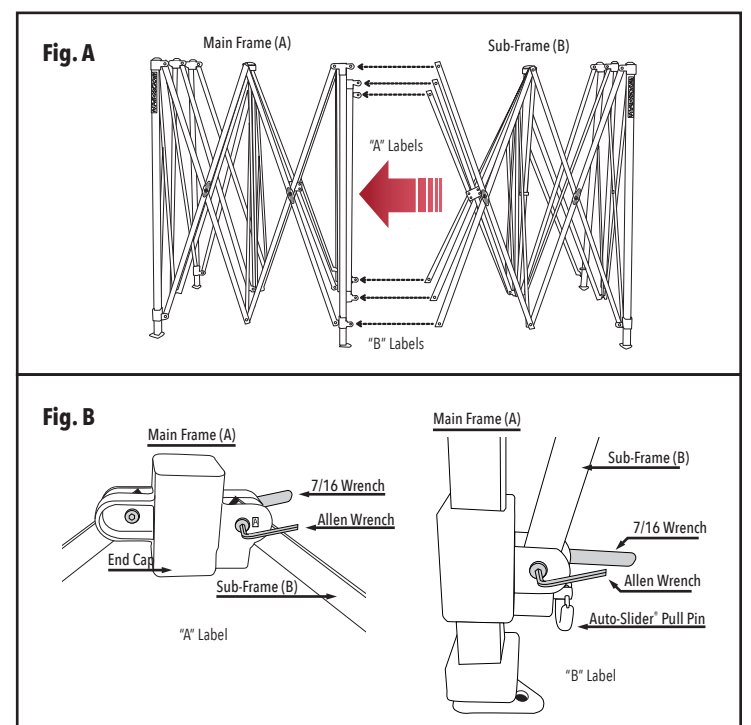
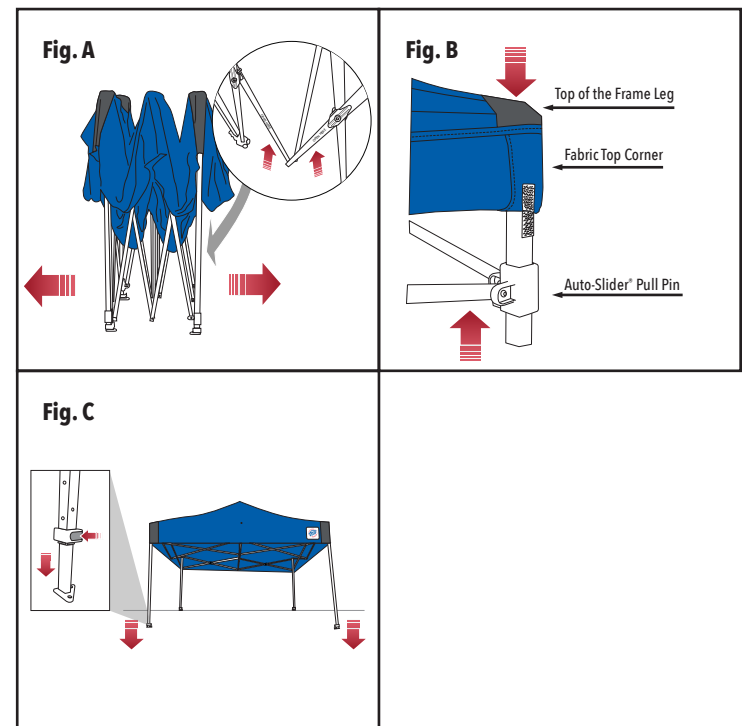
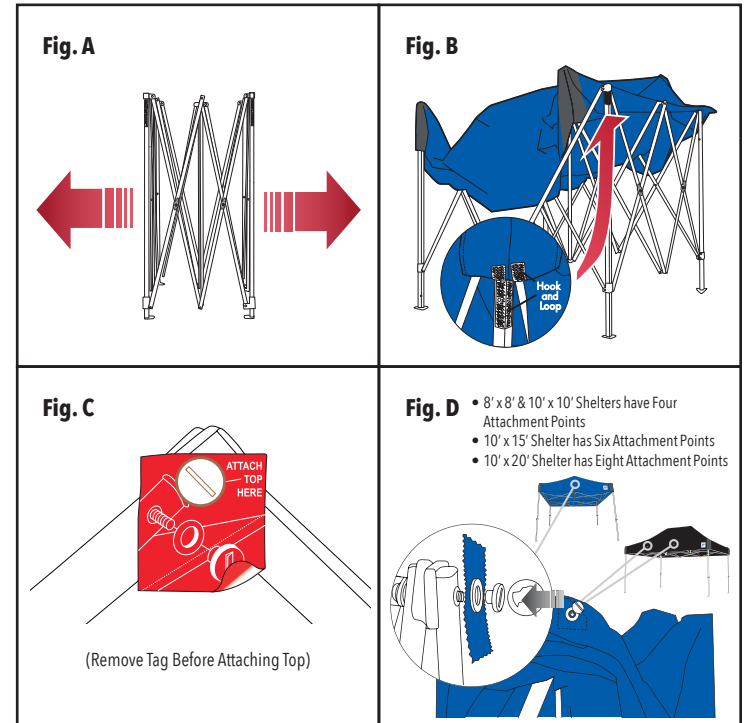



## TAKEDOWN

### FOR 10' X 20' (3.0m x 6.0m) MODEL ONLY:

Depress the toggle button on one of the middle legs to slide the lower/inner leg section into the upper/outer leg, then proceed with the instructions below.

#### Collapse Shelter Legs

1. With a partner, slightly lift two adjacent corner legs simultaneously.
2. Depress the **Toggle** and slide lower/inner legs into upper/outer legs, making sure to do two legs at a time on the same side. (Fig A)
3. Repeat on remaining legs.

Note: Keep the Toggle depressed while retracting leg.

#### Release Auto-Slider® Pull Pin

4. With one hand, slightly push up on the truss near the **Auto-Slider® Pull Pin** to relieve pressure. (Fig B)
5. With the other hand, release the **Auto-Slider® Pull Pin** by pulling the ring.
6. Repeat on remaining legs.

#### Closing Shelter

7. Grasp the **Frame** on the top of the diamond-shaped area of **Center Trusses** on the opposite sides near the "CLOSE HERE" sticker. (Fig C)
8. Lift the shelter up slightly, and shake it while stepping toward your partner until the shelter is approximately ¾ closed. Be careful not to pinch fingers!
9. Grasp the two outer legs, and push the frame together until it is fully closed.
10. Store the shelter in the cover bag provided.

Note: Hug your shelter before placing it in the cover bag.

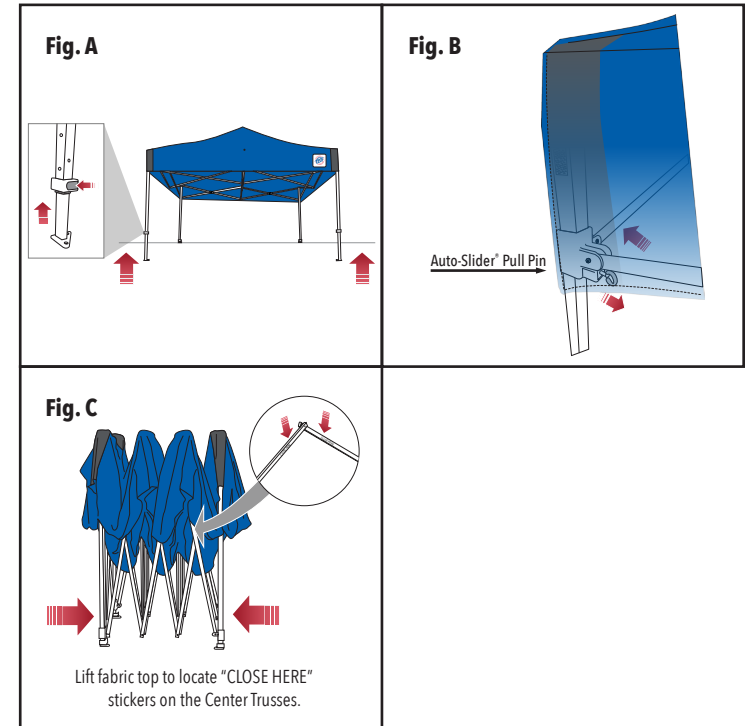

## CARE AND MAINTENANCE

For long lasting durability and the best possible protection for your E-Z UP® Instant Shelter® products, follow these E-Z care and maintenance instructions:

- Use a mild soap (not detergent) and plenty of water for the top cleaning.
- Let the E-Z UP® top and frame dry completely before closing or storing to avoid mildew.
- Frame will operate and look better if occasionally treated with silicone spray, especially before and after use in damp conditions. Remove excess silicone residue before applying top.
- Use a seam sealer (available at most sporting goods and hardware stores) if top leaks or drips water.
- Slightly tighten bolts if frame becomes loose.

## REPLACEMENT PARTS

800-45-SHADE [ezup.com/parts](http://ezup.com/parts)

## WARRANTY INFORMATION

[www.ezup.com/warranties](http://www.ezup.com/warranties)

## CONDITIONS

This warranty shall be void as to any product that has been altered or modified in any manner. This warranty does not apply to damages caused by wind, rain, or other forces of nature, not to accidental or deliberate damage of the product, nor to the use of the product that does not conform with the product instructions. This warranty is provided in lieu of all other warranties, expressed or implied.

## IMPORTANT INFORMATION

Read this information before proceeding. It is the user's responsibility to take the following precautions at all times.

- Always stake or weigh down your E-Z UP® Instant Shelter® product with genuine E-Z UP® accessories. See [ezup.com](http://ezup.com) for products and guidelines. Do not use in any potentially windy or rainy weather.
- Wind and rain can damage the E-Z UP® Instant Shelter® product and also may result in injury to you or others. Therefore, do not rely on your shelter for protection in heavy or prolonged rain storms.
- The E-Z UP® Instant Shelter® product is designed as a temporary shelter. Do not leave up for extended periods.
- Use caution when handling the E-Z UP® folding frame.
- Avoid pinching hands or fingers as frame opens or closes.
- Do not use shelter in a lightning storm.
- Do not leave your E-Z UP® Instant Shelter® product unattended.
- Do not build fires within shelter enclosure.

## WARNING:

Keep all flame and heat sources away from all Instant Shelter® fabrics and accessories. These fabrics meet the flammability requirements of CPAI-84. The fabric may burn if left in continuous contact with any flame source. The application of any foreign substance to the fabric may render the flame-resistant properties ineffective.

CAN/ULC-S109 NATIONAL STANDARD OF CANADA, FLAME TESTS OF FLAME-RESISTANT FABRICS AND FILMS